

Individual mounting

Series

Inline

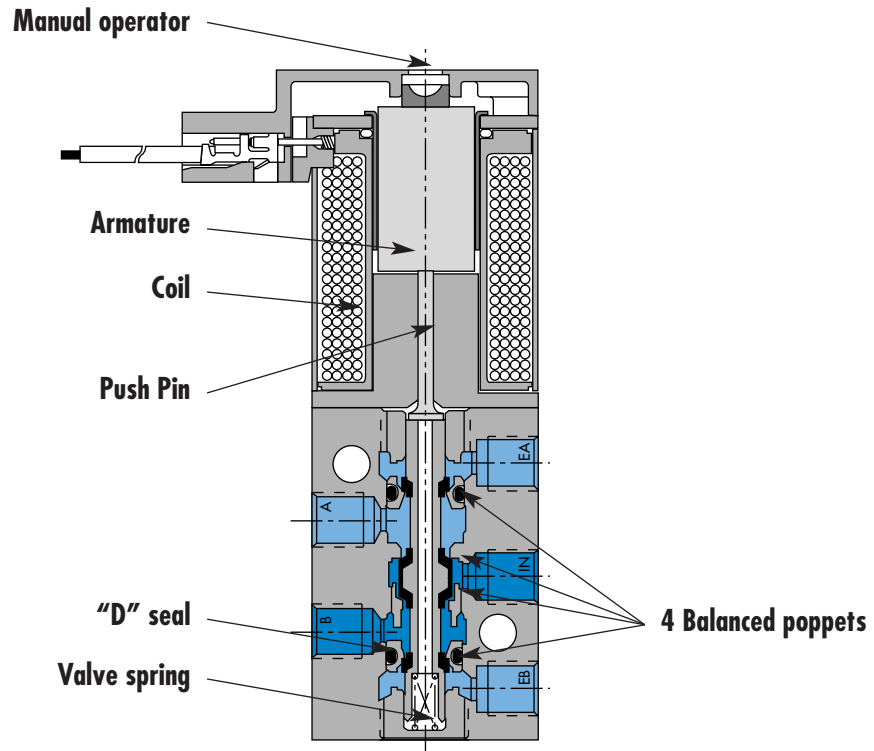

33

34

36

32

37

38

52

67

69

44

46

42

47

48P

48

400

92

SERIES FEATURES

- High force MACSOLENOID®.
- 10mm direct operated.
- # 10-32 or M5 ports.
- Rated for lubricated or non-lubricated service.

93

ISO 01

ISO 02

ISO 1

ISO 2

ISO 3



Direct solenoid and solenoid pilot operated valves

Function	Port size	Flow [Max]	Individual Mounting	Series
5/2	M5, # 10-32	0.1 C_v	Inline	

OPERATIONAL BENEFITS

1. 10 mm valve, direct solenoid operated.
2. Balanced poppet, immune to variations of pressure.
3. Short stroke with high flow.
4. The patented solenoid develops high shifting forces.
5. Powerful return spring.
6. Flow is specifically adjusted on each valve.
7. Manual operator standard on all valves.



33
34
36
32
37
38
52
67
69

HOW TO ORDER

SOLENOID OPERATOR

Port size	Universal valve	For use with external flow controls
M5	44C-ABA-G xxx-xxx	44C-BBA-G xxx-xxx
# 10-32	44C-AAA-G xxx-xxx	44C-BAA-G xxx-xxx

44
46
42
47
48P

SOLENOID OPERATOR >

G **xxx-xxx***

XX Voltage	X Wire length	X Manual operator	XX Electrical connection
AA 120 VAC (2.5W)	A 18"	1 Non-locking recessed	BA Flying leads
DC 24 VDC (1.8W)	B 24"	2 Locking recessed	BT Flying leads with light
DD 24 VDC (2.5W)			GA MAC JAC Solenoid Plug-in
DF 24 VDC (4.0W)			KA Plug-in wire assembly.
			KC Plug-in wire assembly with rectifier & light
			KT Plug-in wire assembly with light

* Other options available, see page 311.
Note : AC voltage requires connector with rectifier

92
93
ISO 01
ISO 02
ISO 1
ISO 2
ISO 3

* Other options available, see page 319.

TECHNICAL DATA

Fluid :	Compressed air, vacuum, inert gases
Pressure range :	Vacuum to 120 PSI
Lubrication :	Not required, if used select a medium aniline point lubricant (between 180°F and 210°F)
Filtration :	40 μ
Temperature range :	0°F to 120°F (-18°C to +50°C)
Flow :	4 W : (0.10 C _v) – 2.5 W : (0.08 C _v) – 1.8 W : (0.06 C _v) – 1.0W : (0.05 C _v)
Coil :	Class A wire (#22 AWG x 18), continuous duty
Voltage range :	-15% to +10% of nominal voltage
Power :	4 W – 2.5 W – 1.8 W – 1.0 W
Response times : (with 4 W coil)	Energize : 3.4 ms De-energize : 1.5 ms

Note : • Valve and coil are not interchangeable.

DIMENSIONS

Dimensions shown are metric (mm)

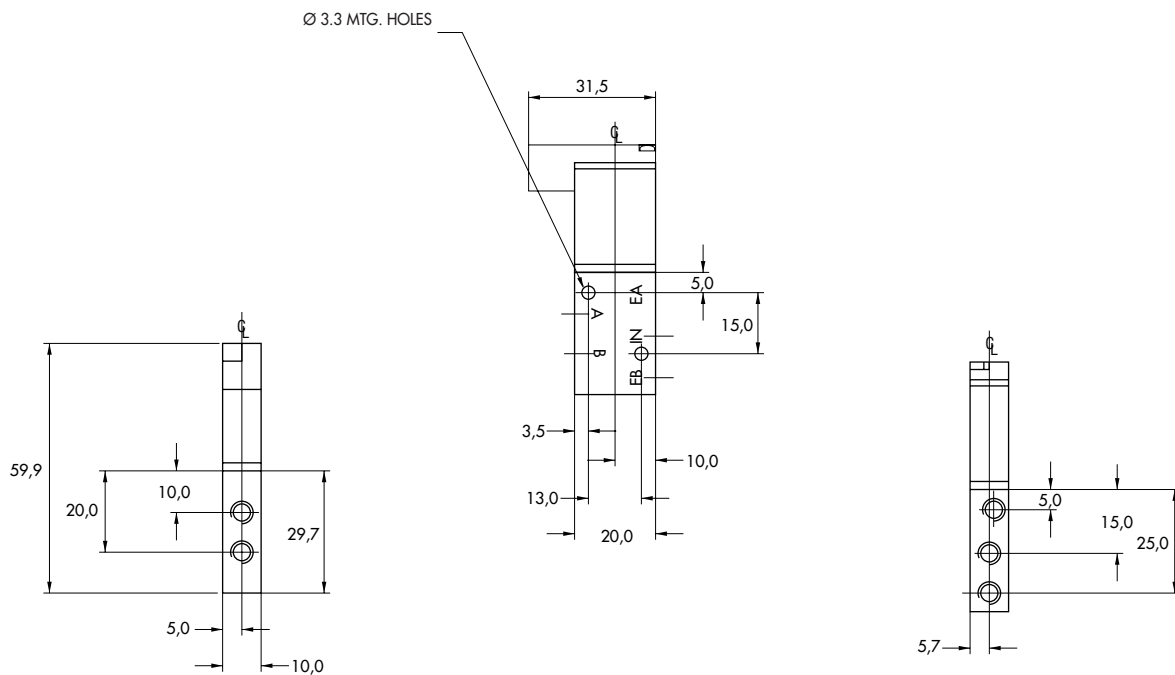

Codification table for voltages / Manual operator / Electrical connection

VALVE CODE > **G XX X-X XX**
1 2 3 4

OPTIONS AVAILABLE FOR

- Solenoid valves 32, 34, 38, 42, 44 & 48 Series

1. VOLTAGE

G-XX X-X XX	VOLTAGE	
AA	120 VAC (2.5W)	Requires electrical connector with rectifier
AC	24 VAC (4.0W)	Requires electrical connector with rectifier
DA	24 VDC (1.0W)	
DC	24 VDC (1.8W)	
DD	24 VDC (2.5W)	
DE	24 VDC (3.0W)	
DF	24 VDC (4.0W)	
DG	12 VDC (1.0W)	
DJ	12 VDC (1.8W)	
DK	12 VDC (2.5W)	
DM	12 VDC (3.0W)	
DN	12 VDC (4.0W)	
DR	6 VDC (1.8W)	
DS	6 VDC (3.0W)	
EB	48 VDC (1.8W)	
EC	48 VDC (3.0W)	
ED	120 VDC (2.5W)	
GD	12 VDC (0.5W)	34 series only
GE	24 VDC (0.5W)	34 series only

2. WIRE LENGTH

G-XX X-X XX	WIRE LENGTH	
0	No lead wires	(used only with "KJ" & "KM" connectors)
A	18" coil leads	
B	24" coil leads	
C	36" coil leads	
D	48" coil leads	
E	72" coil leads	
F	96" coil leads	
G	120" coil leads	
H	144" coil leads	
I	18" base leads	
2	24" base leads	
3	36" base leads	
4	48" base leads	
5	72" base leads	
6	96" base leads	
7	120" base leads	

3. MANUAL OPERATOR

G-XX X-X XX	MANUAL OPERATOR
1	Non-locking recessed
2	Locking recessed
3	Non-locking extended
4	Locking extended

4. ELECTRICAL CONNECTION

G-XX X-X XX	ELECTRICAL CONNECTION
BA	Flying leads
BB	BA with ground wire
BC	BA with light
BD	BA with light and ground wire
BE	BA with suppression diode
BF	BA with suppression diode and ground wire
BG	BA with suppression diode and light
BH	BA with suppression diode, light and ground wire
BN	BA with suppression diode and blocking diode
BP	BA with suppression diode, blocking diode and ground wire
BR	BA with suppression diode, blocking diode and light
BS	BA with suppression diode, blocking diode, light and ground wire
GA	MAC JAC Solenoid plug-in
GB	MAC JAC Solenoid plug-in w/Diode
GC	MAC JAC Solenoid plug-in w/MOV
GD	MAC JAC Solenoid plug-in w/LED
GE	MAC JAC Solenoid plug-in w/Diode & LED
GF	MAC JAC Solenoid plug-in w/MOV & LED
GG	MAC JAC Solenoid plug-in w/Rectifier
GH	MAC JAC Solenoid plug-in w/Rectifier & LED
KA	Solenoid plug-in wire assembly
KB	KA with ground
KC	KA with rectifier and light
KD	KA with rectifier, light and ground
KE	KA with suppression diode
KF	KA with suppression diode and ground
KJ	Solenoid plug-in housing without wire assembly
KM	Solenoid plug-in housing with ground pin without wire assembly
KN	KA with suppression diode and blocking diode
KP	KA with suppression diode, blocking diode and ground
KT	KA with light
KU	KA with light and ground
KV	KA with suppression diode and light
KW	KA with suppression diode, light and ground
KX	KA with suppression diode, blocking diode and light
KY	KA with suppression diode, blocking diode, light & ground

ELECTRICAL CONNECTION FOR PLUG-IN VALVES

G-XX X-X XX	PLUG-IN OPTIONS
SB	Base plug-in with ground
SC	Base plug-in with suppression and blocking diode
SD	Base plug-in with suppression and blocking diode and ground
SE	Base plug-in with MOV
SF	Base plug-in with MOV and ground
SG	Base plug-in with rectifier
SH	Base plug-in with rectifier and ground
SK	Base plug-in with light and ground
SL	Base plug-in with suppression and blocking diode and light
SM	Base plug-in with suppression and blocking diode with light and ground
SN	Base plug-in with MOV and light
SP	Base plug-in with MOV and light with ground
SR	Base plug-in with rectifier and light